



EQUIPMENT

## MEAT GRINDER PG-22-2L



The PG-22-2L Meat Grinder is a mid-sized countertop designed grinder, suitable for almost any need of a meat market or hotel, producing at least 810 Kg/hr.! It incorporates a larger feed chute that allows for output of a larger grinder at a more reasonable price. Equipped with a 2 HP motor, this unit is even more efficient than the PG-22-L, and only a trace heavier. With a fully stainless steel body, this model is easy to use, clean, & disassemble. Powerline Grinders are specifically designed for long life.

### STANDARD FEATURES

- Equipped with powerful 2 HP motor
- Stainless steel construction
- Safety guard
- Easy to clean
- Steel gear transmission
- Oil layered/bathed steel to eliminate corrossions/friction
- Knife, 3/16" plate & stomper included
- High capacity head increases efficiency through holding the bigger pieces into the system
- Adjustable legs & deep pan
- Easily disassembled
- No belts or pulleys
- Cast iron grinding system reinforced with tin plating



With a wide variety of sieves, Processing almost anything is possible. Even dips, salsa's, beans, guacamole, and even jam/jelly spreads are feasible.



With a stainless steel cabinet + tray, this unit is both visually and hygienically appealing. An added bonus to this fine unit is that it is easily cleaned without tools.



This larger and more powerful unit has an incredible production level while retaining medium size, up to 13.5 kg a minute. This efficient and economical unit is the ideal machine.

# MEAT GRINDER PG-22-2L

## Technical Data

Motor L version	2HP 1.492 kW
Electric	115/60/1 or 220/50/60/1
Grinding capacity first ground	13.5 Kg/min (29.76 lbs./min) (3/8")
Grinding capacity second ground	7 Kg/min (15.43 lbs./min) (1/8")
Pan dimensions (L x W x H)	763.5 mm x 420 mm x 80.9 mm (30.06" x 16.54" x 9.84")
Machine dimensions (L x W x H)	790.1 mm x 420 mm x 521.9 mm (31.11" x 16.54" x 16.62")
Net weight	62.5 Kg (137.79lbs)
Shipping weight	80 Kg (176.37lbs)

## Detail & Dimensions

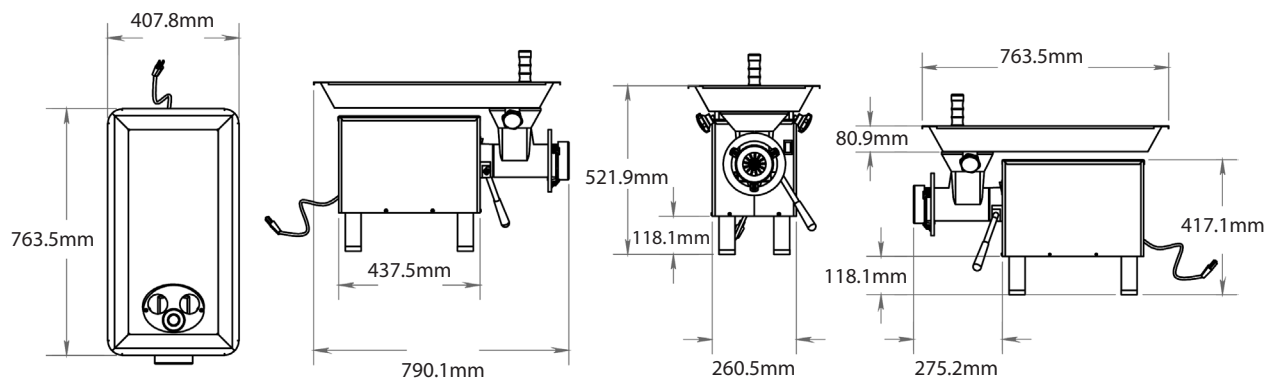

Safety & Sanitation  
Conforms UL  
std 763

Conforms  
NSF-8

CANADA  
Conforms CAN/CSA  
STD C22.2

As continued product improvement is a policy of Powerline, specifications are subject to change without notice.



**POWERLINE EQUIPMENT COMPANY**

Pulaski Street, Norwalk, CT 06851 USA. Tel: 203-847 2357 Fax: 203-847 6480

[www.powerlineequip.com](http://www.powerlineequip.com)