



EQUIPMENT

HEAVY DUTY GRIDDLE PTC 24-24 G/TG



STANDARD FEATURES

- Fully stainless steel exterior
- 4" (101.6 mm) adjustable legs
- Gas pressure regulator
- 1 heavy duty cast iron burner every 12" (30,000 BTU/HR)
- 21.5" (546.1 mm) working depth
- 4" (101.6 mm) plate rail
- 5/8" (15.88 mm) thick polished steel plate
- Large grease container and lid
- Spatula width grease area
- **G** : Every 12" section controlled by a manual valve
- **TG** : Every 24" section controlled by a thermostat
- **TG** : Temperature range 150°-400°F (65.56°-204.44°C)

AVAILABLE OPTIONS

- Grooved griddles
- 1" (25.4 mm) thick griddle plate
- Stainless steel equipment stand
- Stainless steel back cover & flue riser
- Optional casters
- **Manual valve control option (Model G)**
- **Thermostat control option (Model TG)**

HEAVY DUTY GRIDDLE PTC 24-24 G/TG

Technical Data

Burner power	30,000 BTU/Hr. (8.79 kW)
Manifold inlet connection	3/4" NPT 5" WC natural 10" WC propane
Total gas consumption	60,000 BTU/Hr. (17.59 kW)
Gas pressure	12.45 mbar natural 24.9 mbar propane
Clearances (back)	6" (152.4 mm) Non-Combustible 12" (304.8 mm) Combustible
Clearances (side)	0" Non-Combustible 6" (152.4 mm) Combustible
Machine dimensions (LxWxH)	30.25" x 24" x 12" (768.35 mm x 609.6 mm x 304.8 mm)
Gross weight	250 lbs (113.4 Kg)

Detail & Dimensions

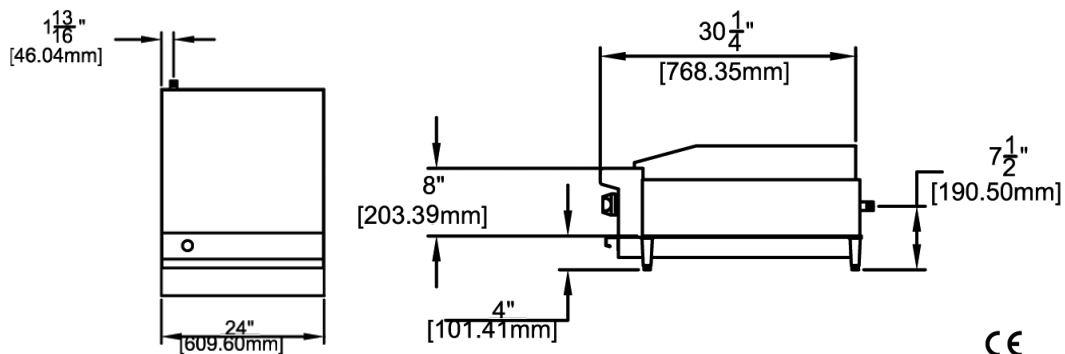

As continued product improvement is a policy of Powerline, specifications are subject to change without notice.



POWERLINE EQUIPMENT COMPANY

Pulaski Street, Norwalk, CT 06851 USA. Tel: 203-847 2357 Fax: 203-847 6480

www.powerlineequip.com