



EQUIPMENT

CHAR ROCK BROILER PTC 24-24 RB/CRB



STANDARD FEATURES

- Fully stainless steel exterior
- 4" (101.6 mm) adjustable legs
- Gas pressure regulator
- 1 heavy duty cast iron burner every 12" (30,000 BTU/HR)
- Heavy duty cast iron grates for maximum heat retention and efficiency. Grates minimize recovery time
- Single piece brass (heat) control valves
- Spatula width grease area
- Drip pans easy to remove
- **CRB** : Lava rocks excellent for heat retention, perfect for broiling
- **CRB** : Heat shield protects burners and prevents any sort of clogging
- **RB** : Heavy cast iron radiants. Multiple heat sinks minimize recovery time, prevent clogging and flare ups, & retain heat. 2 radiants per burner
- **RB** : Burners are designed to move heat from the drip pan to the cooking area

AVAILABLE OPTIONS

- Lava rock bags
- Propane or natural gas powered
- Stainless steel equipment stand
- Optional casters
- CE approved flame failure device
- **Char rock broiler option (Model CRB)**
- **Radiant broiler option (Model RB)**

CHAR ROCK BROILER PTC 24-24 RB/CRB

Technical Data

Burner power	30,000 BTU/Hr. (8.79 kW)
Manifold inlet connection	3/4"NPT 5"WC natural 10"WC propane
Total gas consumption	60,000 BTU/Hr. (17.59 kW)
Gas pressure	12.45 mbar natural 24.9 mbar propane
Machine dimensions (LxWxH)	30.25" x 24" x 12" (768.35 mm x 609.6 mm x 304.8 mm)
Gross weight	310 lbs (140.61 Kg)

Detail & Dimensions

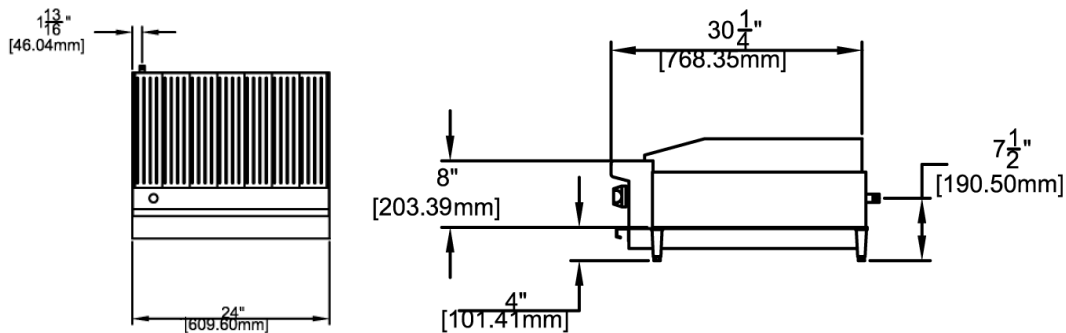

As continued product improvement is a policy of Powerline, specifications are subject to change without notice.



POWERLINE EQUIPMENT COMPANY

Pulaski Street, Norwalk, CT 06851 USA. Tel: 203-847 2357 Fax: 203-847 6480

www.powerlineequip.com