



EQUIPMENT

SALAMANDER BROILER PTSM 36



STANDARD FEATURES

- Fully stainless steel exterior
- 4" (101.6 mm) adjustable legs
- Gas pressure regulator
- 5.86 kW burner (20,000 BTU/HR)
- Ignition by standing pilot for each individually controlled burner
- 365in² chrome plated rack
- Rack easily adjustable: 4 positions & an assembly to ensure easy loading & unloading
- Grease deflectors direct drippings to large pan
- Two steel wired mesh infrared burners
- Rack carriage and drip pan easily removed

AVAILABLE OPTIONS

- Interconnecting piping between salamander & range
- Range mount kit
- Counter mount kit
- Wall mount kit
- Additional rack
- CE approved flame failure device

SALAMANDER BROILER PTSM 36

Technical Data

Burner power	20,000 BTU/Hr. (5.86 kW)
Manifold inlet connection	1/2"NPT 5"WC natural 10"WC propane
Total gas consumption	40,000 BTU/Hr. (11.72 kW)
Gas pressure	12.45 mbar natural 24.9 mbar propane
Clearances (sides & back)	0" Combustible 6" (152.4mm) Non-Combustible
Machine dimensions (LxWxH)	17.75" x 36" x 16.75" (450.85 mm x 914.4 mm x 425.45 mm)
Gross weight	215 lbs (97.52 Kg)

Detail & Dimensions

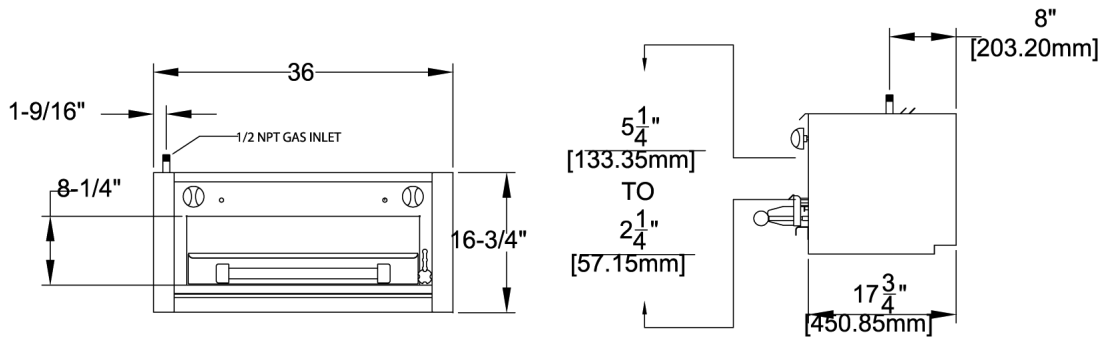

As continued product improvement is a policy of Powerline, specifications are subject to change without notice.



POWERLINE EQUIPMENT COMPANY

Pulaski Street, Norwalk, CT 06851 USA. Tel: 203-847 2357 Fax: 203-847 6480

www.powerlineequip.com